

WEST SUSSEX COUNTY COUNCIL
((HORSHAM DISTRICT) (PARKING PLACES AND TRAFFIC REGULATION)
(CONSOLIDATION NO. 2) ORDER 2006)
(BILLINGSHURST CPZ AMENDMENT) ORDER 2014

BILLINGSHURST: LOCATION OF WAITING RESTRICTIONS



Key for Waiting Restrictions

All areas over which the provision of the orders apply are defined by the shaded areas as shown on the following plans plus a contiguous area not indicated on the plans of verge and/or footway between the carriageway edge and the highway boundary. The plans in this schedule are based upon grid references of the Ordnance Survey National Grid defined by the OSGB 36 triangulation.

Prohibition of waiting at any time

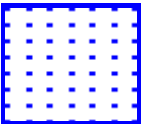
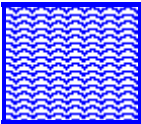
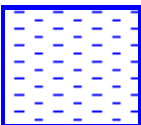
101		check	No waiting at any time	112		dot5	No waiting 8.00am-6.00pm Mon-Fri
105		smallwave2	No waiting 8.00am-6.00pm any day	116		pat064	No waiting 10.00am-11.00am, 2.00pm-3.00pm Mon-Fri

Charged on-street parking

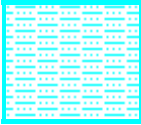
325		usgs616	Pay and Display 9.00am-5.00pm Mon-Sat
-----	--	---------	---------------------------------------

Residents Parking

520		dot5	Residents' and Visitors' permit holders only 10.00am-11.00am and 2.00pm-3.00pm Mon-Fri	521		usgs601	Residents' and Visitors' only past this point 10.00am-11.00am and 2.00pm-3.00pm Mon-Fri
-----	---	------	---	-----	---	---------	--

Shared Residents Parking & Free Limited Waiting

626		gravel	Residents' and Visitors' permit holders and Limited waiting for 4hrs No return within 2hrs for non-permit holders 8.00am-6.00pm Mon-Fri	627		shingle	Residents' and Visitors' permit holders and Limited waiting for 2hrs No return within 2hrs for non-permit holders 8.00am-6.00pm Mon-Fri
-----	---	--------	---	-----	---	---------	---

Specified Vehicles

810

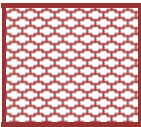

usgs503

Loading bay-Goods vehicles only at any time

Clearways

1100



usgs503

School Keep Clear-No stopping at any time



Boundary of Controlled Parking Zone

WEST SUSSEX COUNTY COUNCIL
((HORSHAM DISTRICT) (PARKING PLACES AND TRAFFIC REGULATION)
(CONSOLIDATION NO. 2) ORDER 2006)
(BILLINGSHURST CPZ AMENDMENT) ORDER 2014

West Sussex County Council in exercise of their powers under Sections 1 (1) 2 (1) and (2), 4 (2), 45, 46, 49 and 53 and Part IV of Schedule 9 of the Road Traffic Regulation Act 1984 "the Act" as amended and of all other enabling powers and after consultation with the chief officer of police in accordance with Part III of Schedule 9 to the Act hereby make the following Order:-

1. This Order shall come into operation on the 3rd day of November 2014 and may be cited as "West Sussex County Council ((Horsham District) (Parking Places and Traffic Regulation) (Consolidation No. 2) Order 2006) (Billingshurst CPZ Amendment) Order 2014."
2. The "West Sussex County Council (Horsham District) (Parking Places and Traffic Regulation) (Consolidation No.2) Order 2006" is hereby amended by the deletion from it of the plans specified in the First Schedule to this Order, the substitution of the plans attached in the Second Schedule to this Order, the insertion of the plans attached in the Third Schedule to this Order, and, by the addition to the Schedule of Charges and Tariffs of the Fourth Schedule to this Order and, by the addition to the Schedule of List of Streets and parts of Streets within the Controlled Parking Zone of the Fifth Schedule to this Order

FIRST SCHEDULE
Plan numbers to be revoked

TQ0824NEN (Issue No. 3)
TQ0825NEN (Issue No. 3)
TQ0825NES (Issue No. 3)
TQ0825NWN (Issue No. 2)
TQ0825SEN (Issue No. 5)
TQ0825SES (Issue No. 4)
TQ0826SEN (Issue No. 3)
TQ0826SES (Issue No. 5)
TQ0925SWS (Issue No. 2)

SECOND SCHEDULE
Plans to be substituted
(as attached)

TQ0824NEN (Issue No. 4)
TQ0825NEN (Issue No. 4)
TQ0825NES (Issue No. 4)
TQ0825NWN (Issue No. 3)
TQ0825SEN (Issue No. 6)
TQ0825SES (Issue No. 5)
TQ0826SEN (Issue No. 4)
TQ0826SES (Issue No. 6)
TQ0925SWS (Issue No. 3)

THIRD SCHEDULE
Plans to be inserted
(as attached)

TQ0824NES (Issue No.1)
TQ0825NWS (Issue No. 1)
TQ0825SWN (Issue No. 1)
TQ0924NWN (Issue No. 1)

FOURTH SCHEDULE

Lists of streets and parts of streets within the Controlled Parking Zone(s)

Billingshurst CPZ

Zone A

Brookers Road
Brookfield Way
Chestnut Road
Daux Avenue
Daux Way
Lower Station Road
Myrtle Lane
Rosier Way
Station Road – Saville Court, Weald Court, Odds 27-31 and 45-55A, Evens 26-38A
Woodlands Way

FIFTH SCHEDULE

Charges and Tariffs

Billingshurst CPZ

1st resident Permit £20.00 per annum
Subsequent resident permit £40.00 per annum
Non-resident permit & trader permit £150.00 per annum
2 hour residents visitors permit £0.35
Dispensation notice £5.00 a day/£25.00 a week

Pay and Display

Daux Road
8am - 6pm Monday to Friday £0.50 per hour

The COMMON SEAL of WEST SUSSEX
COUNTY COUNCIL was hereto affixed

the Twenty EIGHTH day of OCTOBER 2014
in the presence of

Authorised Signatory

I HEREBY CERTIFY THIS TO
BE A TRUE COPY OF THE
ORIGINAL DOCUMENT

Authorised Officer

WEST SUSSEX COUNTY COUNCIL

)
)
)
)
) (L.S.)
)
)
)



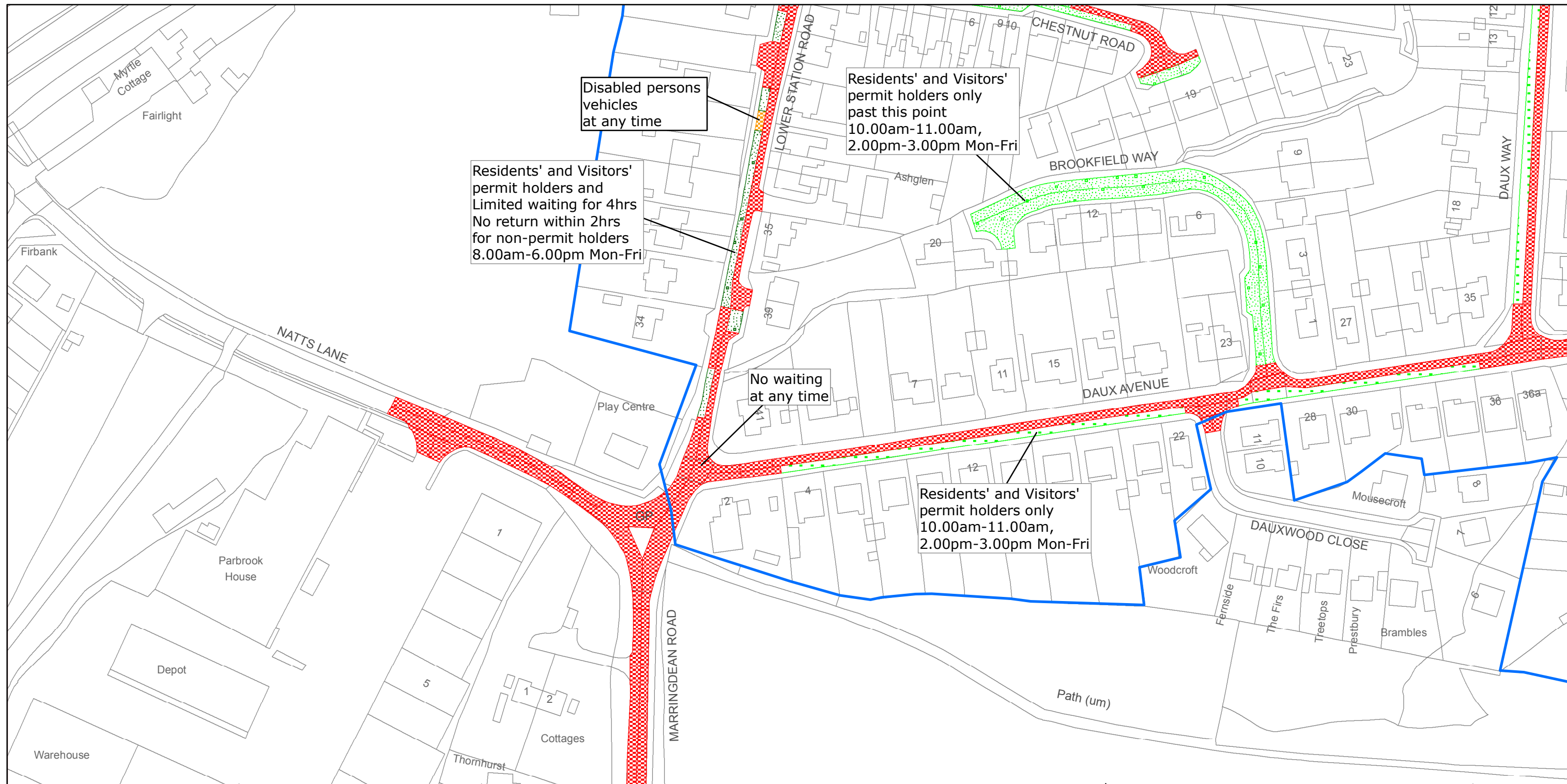

West Sussex County Council
Highways & Transport
The Grange
Tower Street
Chichester
West Sussex
PO19 1RH

HORSHAM DISTRICT: BILLINGSHURST

WAITING RESTRICTIONS

Reproduced from or based upon 2013 Ordnance Survey material with permission of the Controller of HMSO (c) Crown Copyright reserved.
Unauthorised reproduction infringes Crown copyright and may lead to prosecution or civil proceedings West Sussex County Council Licence No. 100023447

TILE REF NO: TQ0824NEN

SHEET ISSUE NO 4
SHEET ACTIVE FROM - 03/11/2014



SCALE:
1:1250
at A3 size

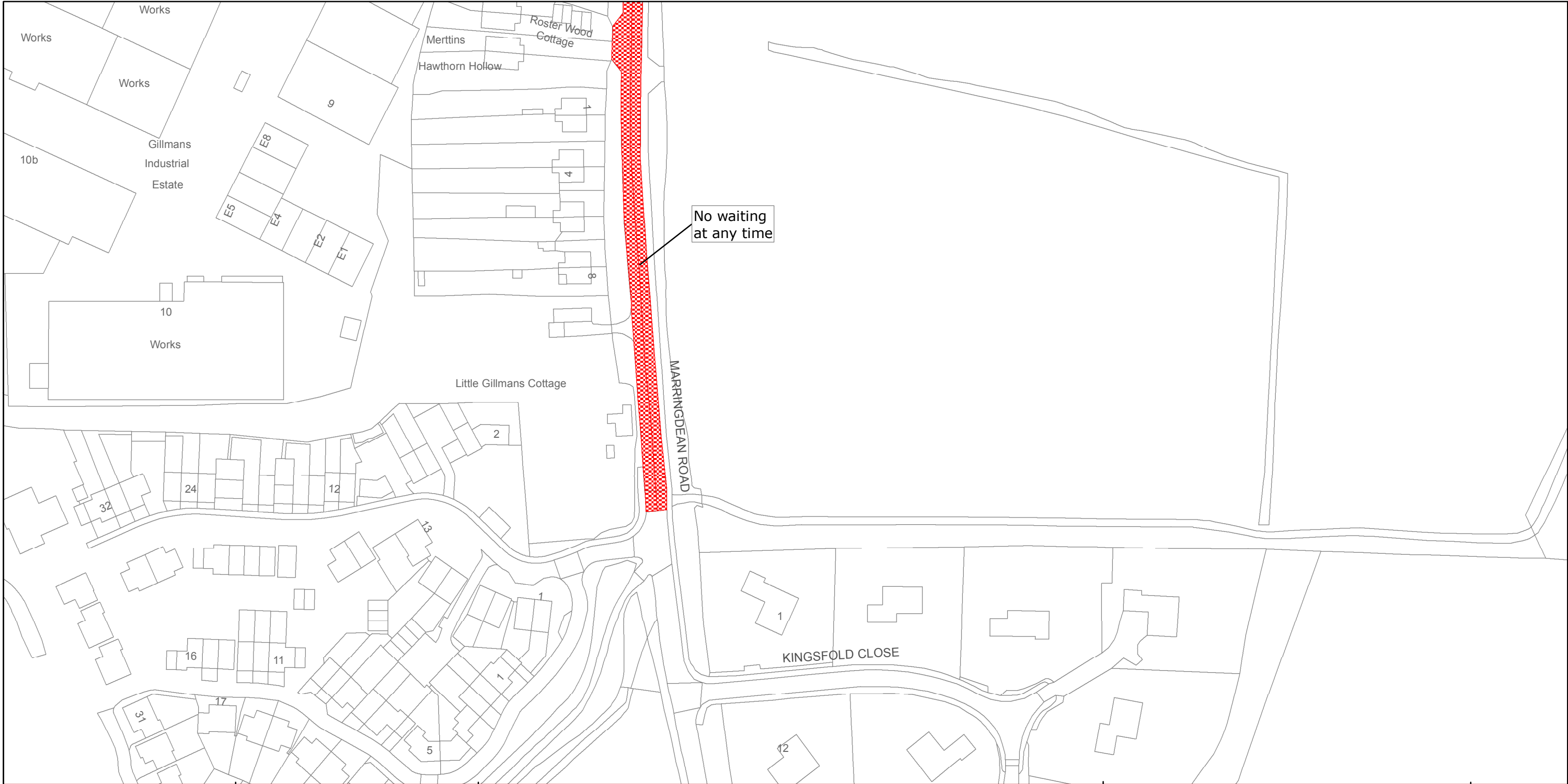

West Sussex County Council
Highways & Transport
The Grange
Tower Street
Chichester
West Sussex
PO19 1RH

HORSHAM DISTRICT: BILLINGSHURST

WAITING RESTRICTIONS

Reproduced from or based upon 2013 Ordnance Survey material with permission of the Controller of HMSO (c) Crown Copyright reserved.
Unauthorised reproduction infringes Crown copyright and may lead to prosecution or civil proceedings West Sussex County Council Licence No. 100023447

TILE REF NO:
TQ0824NES

SHEET ISSUE NO 1
SHEET ACTIVE FROM - 03/11/2014



N

SCALE:
1:1250
at A3 size

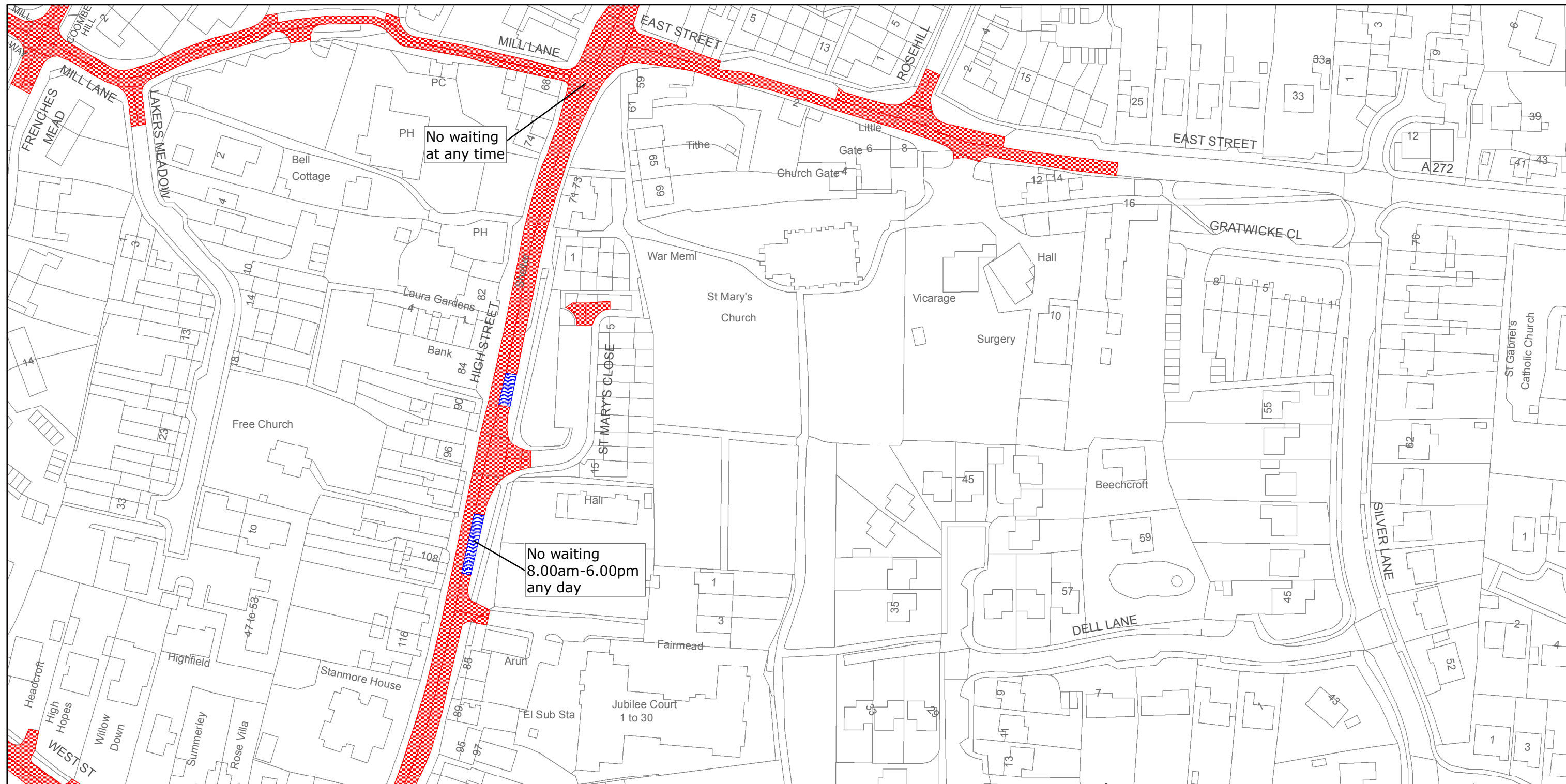

West Sussex County Council
Highways & Transport
The Grange
Tower Street
Chichester
West Sussex
PO19 1RH

HORSHAM DISTRICT: BILLINGSHURST
WAITING RESTRICTIONS

Reproduced from or based upon 2013 Ordnance Survey material with permission of the Controller of HMSO (c) Crown Copyright reserved.
Unauthorised reproduction infringes Crown copyright and may lead to prosecution or civil proceedings West Sussex County Council Licence No. 100023447

TILE REF NO:
TQ0825NEN

SHEET ISSUE NO 4
SHEET ACTIVE FROM - 03/11/2014



SCALE:
1:1250
at A3 size

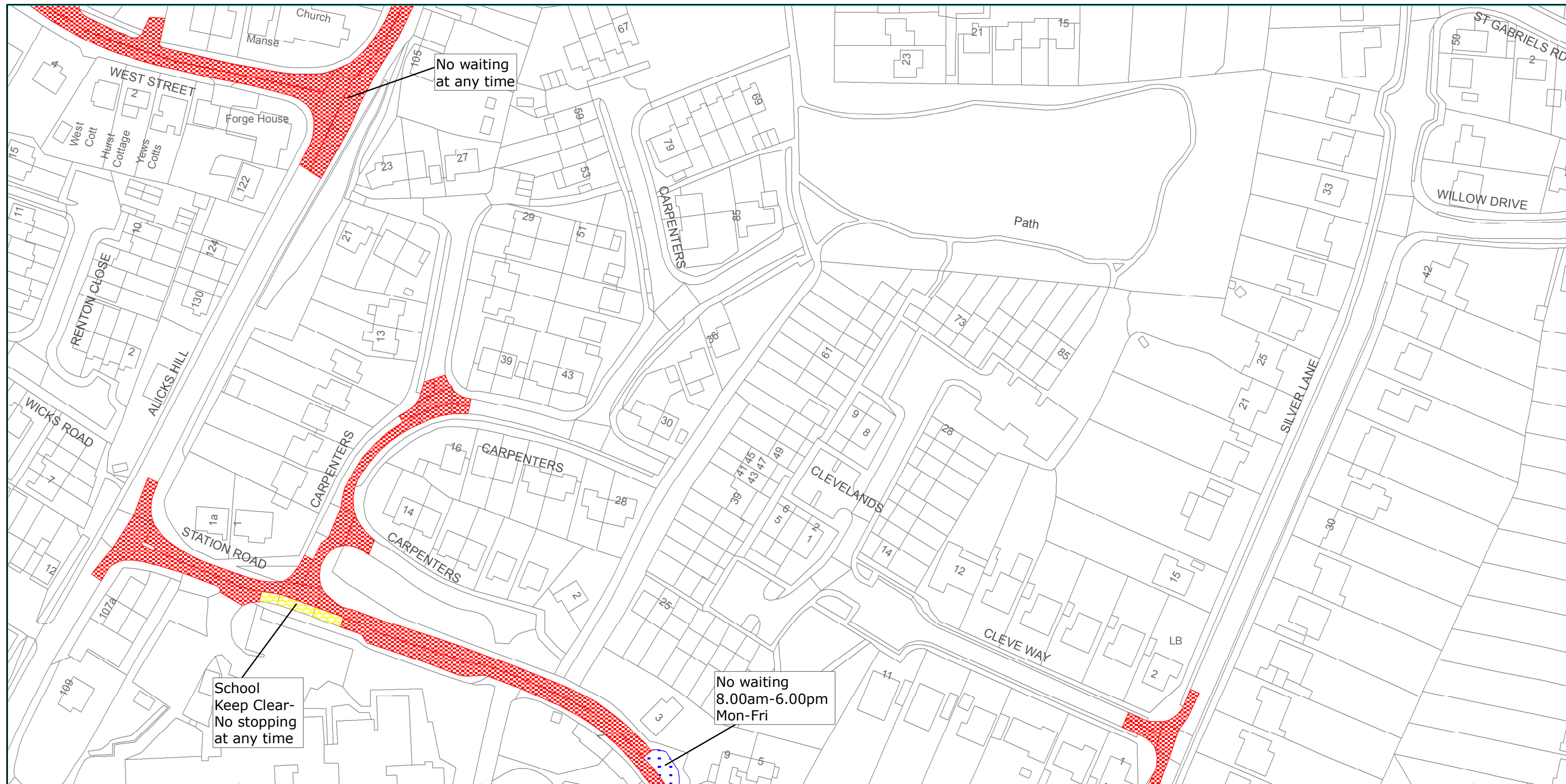

West Sussex County Council
Highways & Transport
The Grange
Tower Street
Chichester
West Sussex
PO19 1RH

HORSHAM DISTRICT: BILLINGSHURST
WAITING RESTRICTIONS

Reproduced from or based upon 2013 Ordnance Survey material with permission of the Controller of HMSO (c) Crown Copyright reserved.
Unauthorised reproduction infringes Crown copyright and may lead to prosecution or civil proceedings West Sussex County Council Licence No. 100023447

TILE REF NO:
TQ0825NES

SHEET ISSUE NO 4
SHEET ACTIVE FROM - 03/11/2014



SCALE:
1:1250
at A3 size



West Sussex County Council
Highways & Transport
The Grange
Tower Street
Chichester
West Sussex
PO19 1RH

HORSHAM DISTRICT: BILLINGSHURST
WAITING RESTRICTIONS

Reproduced from or based upon 2013 Ordnance Survey material with permission of the Controller of HMSO (c) Crown Copyright reserved.
Unauthorised reproduction infringes Crown copyright and may lead to prosecution or civil proceedings West Sussex County Council Licence No. 100023447

TILE REF NO:
TQ0825NWN

SHEET ISSUE NO 3
SHEET ACTIVE FROM - 03/11/2014



SCALE:
1:1250

at A3 size



West Sussex County Council
Highways & Transport
The Grange
Tower Street
Chichester
West Sussex
PO19 1RH

Reproduced from or based upon 2013 Ordnance Survey material with permission of the Controller of HMSO (c) Crown Copyright reserved.
Unauthorised reproduction infringes Crown copyright and may lead to prosecution or civil proceedings West Sussex County Council Licence No. 100023447

HORSHAM DISTRICT: BILLINGSHURST
WAITING RESTRICTIONS

No waiting
at any time

TILE REF NO:
TQ0825NWS

SHEET ISSUE NO 1
SHEET ACTIVE FROM - 03/11/2014



SCALE:
1:1250
at A3 size

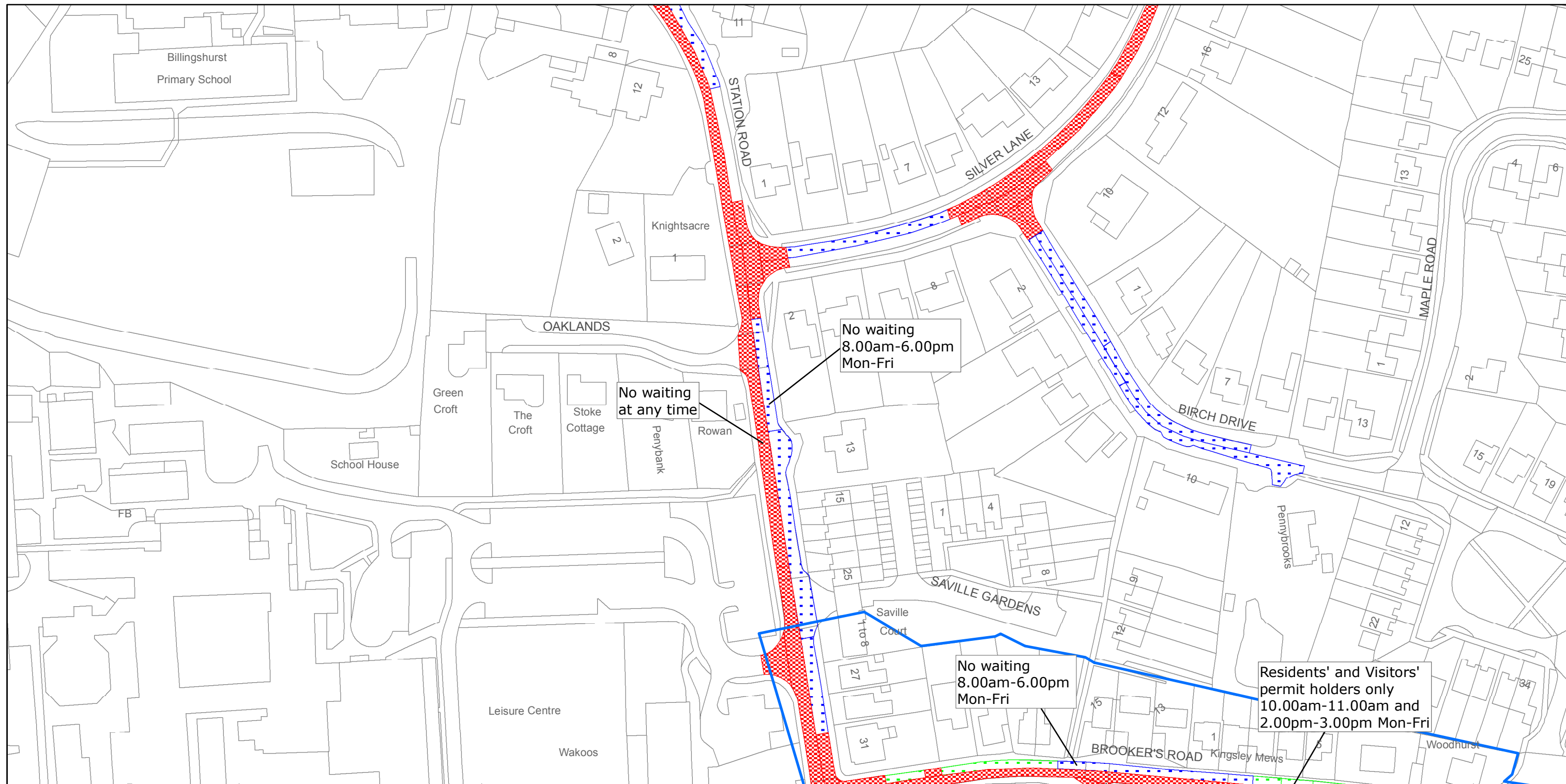

West Sussex County Council
Highways & Transport
The Grange
Tower Street
Chichester
West Sussex
PO19 1RH

HORSHAM DISTRICT: BILLINGSHURST
WAITING RESTRICTIONS

Reproduced from or based upon 2013 Ordnance Survey material with permission of the Controller of HMSO (c) Crown Copyright reserved.
Unauthorised reproduction infringes Crown copyright and may lead to prosecution or civil proceedings West Sussex County Council Licence No. 100023447

TILE REF NO:
TQ0825SEN

SHEET ISSUE NO 6
SHEET ACTIVE FROM - 03/11/2014



SCALE:
1:1250
at A3 size

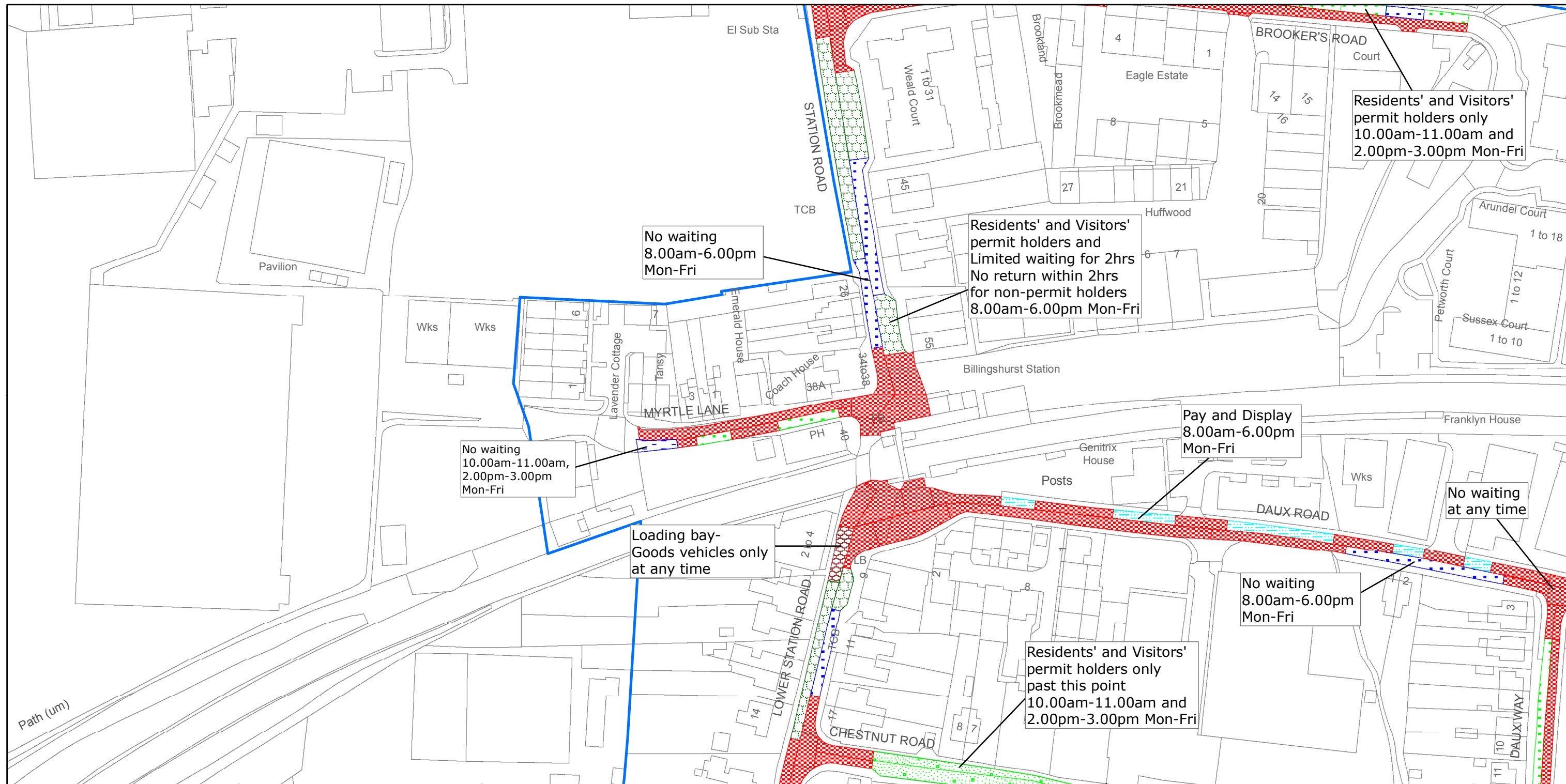

West Sussex County Council
Highways & Transport
The Grange
Tower Street
Chichester
West Sussex
PO19 1RH

HORSHAM DISTRICT: BILLINGSHURST

WAITING RESTRICTIONS

Reproduced from or based upon 2013 Ordnance Survey material with permission of the Controller of HMSO (c) Crown Copyright reserved.
Unauthorised reproduction infringes Crown copyright and may lead to prosecution or civil proceedings West Sussex County Council Licence No. 100023447

TILE REF NO:
TQ0825SES

SHEET ISSUE NO 5
SHEET ACTIVE FROM - 03/11/2014



SCALE:
1:1250
at A3 size

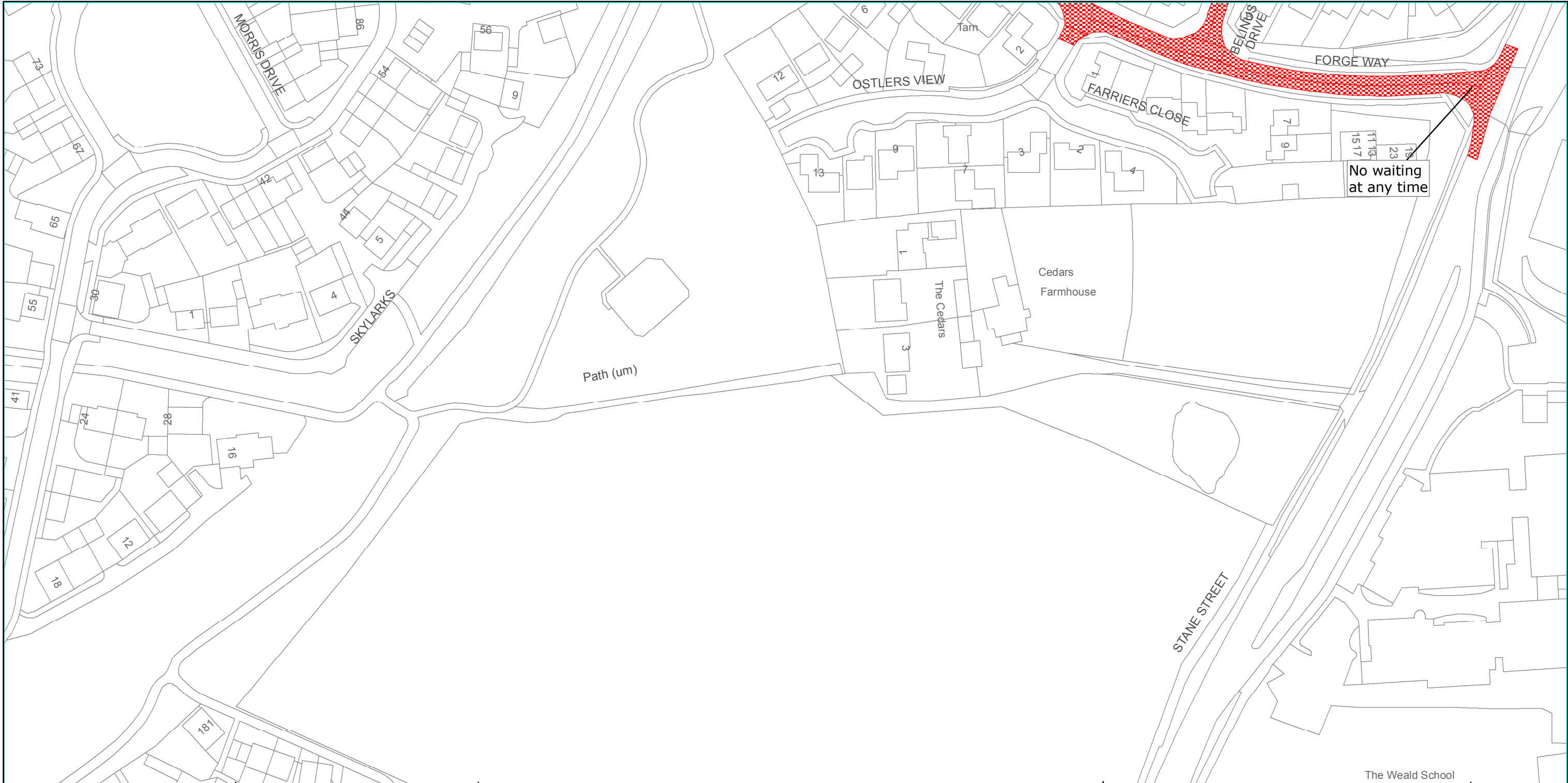

West Sussex County Council
Highways & Transport
The Grange
Tower Street
Chichester
West Sussex
PO19 1RH

HORSHAM DISTRICT: BILLINGSHURST
WAITING RESTRICTIONS

Reproduced from or based upon 2013 Ordnance Survey material with permission of the Controller of HMSO (c) Crown Copyright reserved.
Unauthorised reproduction infringes Crown copyright and may lead to prosecution or civil proceedings West Sussex County Council Licence No. 100023447

TILE REF NO:
TQ0825SWN

SHEET ISSUE NO 1
SHEET ACTIVE FROM - 03/11/2014



SCALE:
1:1250
at A3 size

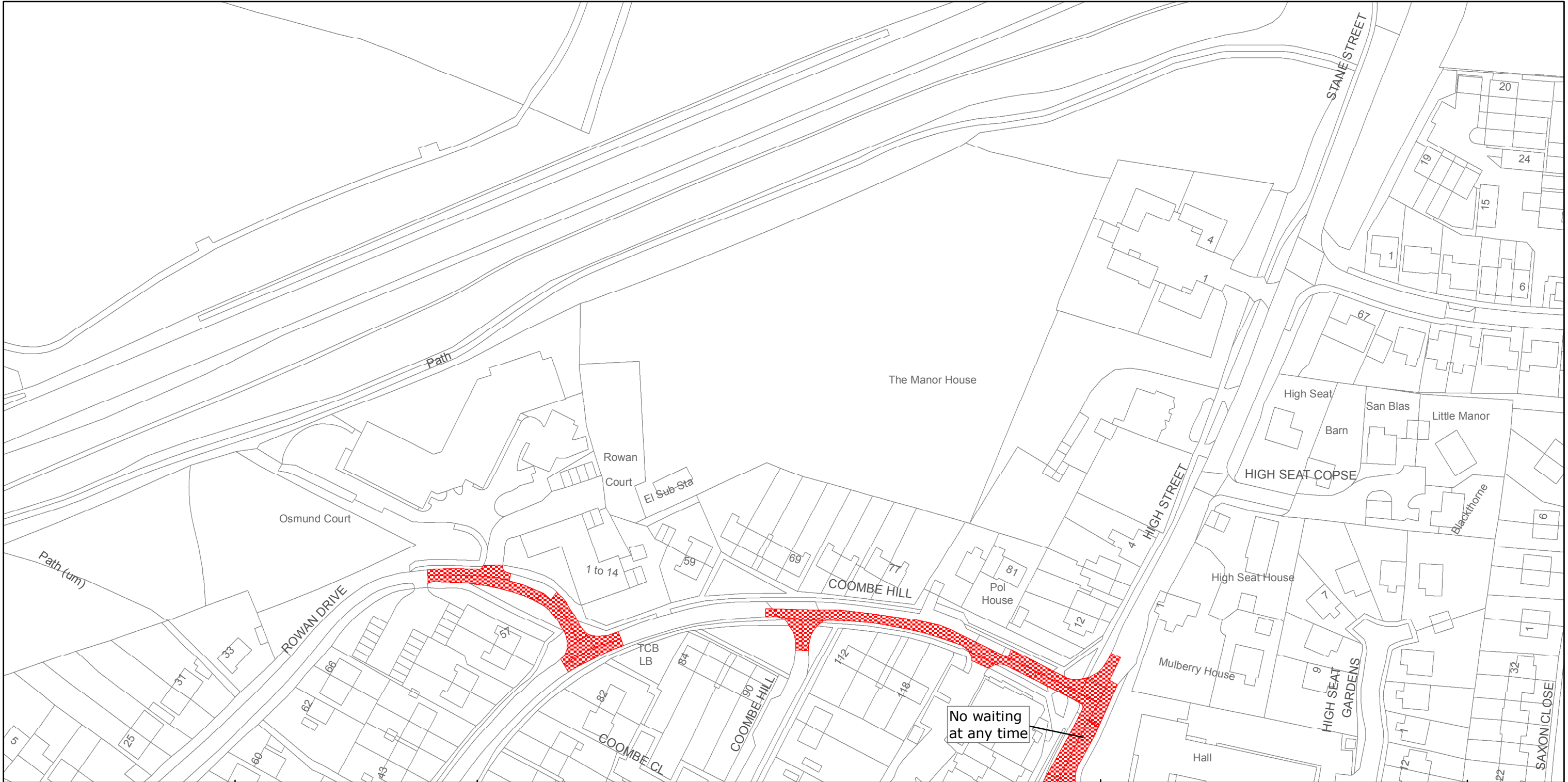

West Sussex County Council
Highways & Transport
The Grange
Tower Street
Chichester
West Sussex
PO19 1RH

HORSHAM DISTRICT: BILLINGSHURST
WAITING RESTRICTIONS

Reproduced from or based upon 2013 Ordnance Survey material with permission of the Controller of HMSO (c) Crown Copyright reserved.
Unauthorised reproduction infringes Crown copyright and may lead to prosecution or civil proceedings West Sussex County Council Licence No. 100023447

TILE REF NO:
TQ0826SEN

SHEET ISSUE NO 4
SHEET ACTIVE FROM - 03/11/2014



SCALE:
1:1250
at A3 size



West Sussex County Council
Highways & Transport
The Grange
Tower Street
Chichester
West Sussex
PO19 1RH

HORSHAM DISTRICT: BILLINGSHURST
WAITING RESTRICTIONS

Reproduced from or based upon 2013 Ordnance Survey material with permission of the Controller of HMSO (c) Crown Copyright reserved.
Unauthorised reproduction infringes Crown copyright and may lead to prosecution or civil proceedings West Sussex County Council Licence No. 100023447

TILE REF NO:
TQ0826SES

SHEET ISSUE NO 6
SHEET ACTIVE FROM - 03/11/2014



SCALE:
1:1250
at A3 size

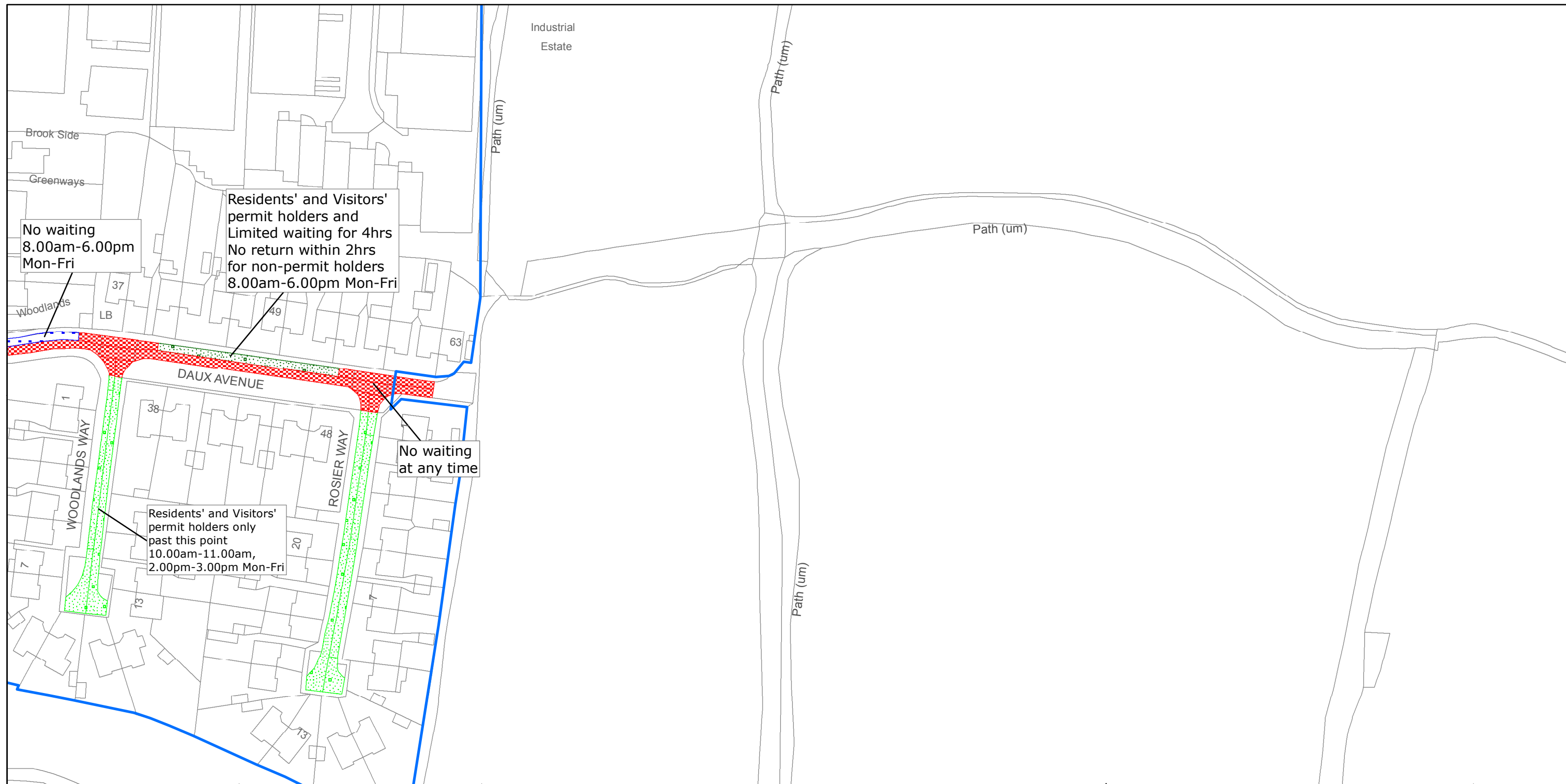

West Sussex County Council
Highways & Transport
The Grange
Tower Street
Chichester
West Sussex
PO19 1RH

HORSHAM DISTRICT: BILLINGSHURST
WAITING RESTRICTIONS

Reproduced from or based upon 2013 Ordnance Survey material with permission of the Controller of HMSO (c) Crown Copyright reserved.
Unauthorised reproduction infringes Crown copyright and may lead to prosecution or civil proceedings West Sussex County Council Licence No. 100023447

TILE REF NO:
TQ0924NWN

SHEET ISSUE NO 1
SHEET ACTIVE FROM - 03/11/2014



SCALE:
1:1250
at A3 size

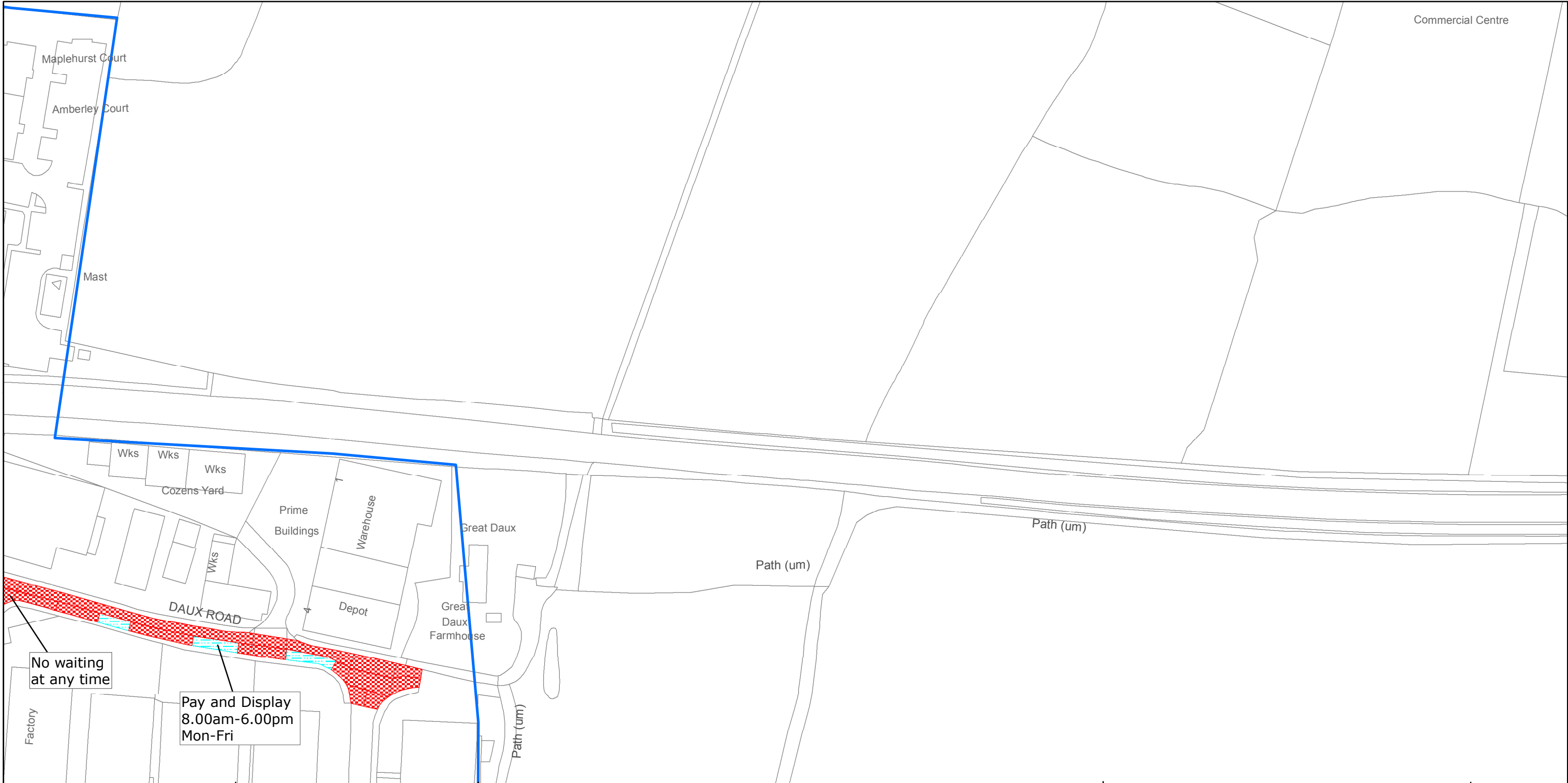

West Sussex County Council
Highways & Transport
The Grange
Tower Street
Chichester
West Sussex
PO19 1RH

HORSHAM DISTRICT: BILLINGSHURST
WAITING RESTRICTIONS

Reproduced from or based upon 2013 Ordnance Survey material with permission of the Controller of HMSO (c) Crown Copyright reserved.
Unauthorised reproduction infringes Crown copyright and may lead to prosecution or civil proceedings West Sussex County Council Licence No. 100023447

TILE REF NO:
TQ0925SWS

SHEET ISSUE NO 3
SHEET ACTIVE FROM - 03/11/2014



SCALE:
1:1250
at A3 size